



# BARUNAH PLAINS





Congratulations on your engagement & thank you for your enquiry to hold your wedding at Barunah Plains. Have a read through the information below as it will give you the details you need for holding your wedding at Barunah Plains. It includes costings, what you have access to and what's included in the hire of the property.

Barunah Plains is a special place offering options that many other venues can't. At Barunah you are gaining access to our private property. We don't have curfew as the only neighbours out here are us. we also don't have locked in suppliers. You can bring in all of your own to make your day uniquely yours. We are however more than happy to recommend people we have used before.

We are excited to be able to offer you our property for your wedding where your guests can all stay and make a weekend of it, or just come for the night and bus everyone back to Geelong. We are located in the heart of the Western district 35 minutes from Geelong, heading towards Hamilton.

Please have a read through the information below and call/email me if you have any questions. As Barunah Plains is a private property we ask that if you do wish to come and see it for yourself to please contact me to make a time. Viewings are strictly by appointment only.

We are so excited to be having weddings at Barunah Plains, bringing new life and history to this beautiful property.

*Ali Callinan*

Ph: 0409 158 706

Bookings and Events

"Barunah Plains" 4484 Hamilton Hwy. Hesse 3321





**L**ocated in the heart of the western district, Barunah Plains dates back to 1866. The Station is strongly associated with the grazing history of the Western District, and prior to soldier settlement in 1946 it was the largest sheep station in Victoria.

Barunah Plains unique homestead was designed by architects Davidson and Henderson. Over the past 5 years the Canny family has undertaken a major renovation project on the homestead to return it to its former glory. It's large formal gardens, stables, ram shed, coach house, woolshed, bluestone cottages, and shearers quarters have or are in the process of being restored. Barunah Plains is back to its magnificent old self! With the homestead, gardens and surrounds the first things done it is now the most incredible back drop for your wedding. The homesteads manicured gardens against the long grass, weaving around the creek and the Merino sheep in the surrounding paddocks, the location is the perfect outlook your wedding. Your guests can admire the homestead and gardens as you wander around all the heritage buildings for your wedding photos. There are so many amazing locations around the property for you to use making the property a unique venue to hold your wedding.

At Barunah Plains you have many choices for your ceremony and wedding. Erect your own marquee on the lawns over the bridge from the Homestead or in any of the paddocks surrounding the homestead. If a marquee is not your style we have the large heritage listed shearing shed that is the perfect spot for a for a wedding reception.

When you hold your wedding at Barunah Plains you are hiring the venue only. You can bring in all of your own suppliers. We are not locked in to any. We are always happy to recommend people who have been used before, Just ask.

Barunah Plains is an Australian icon, why not have your wedding at Barunah and become part of its history.





LOCATIONS

*Below are just a few of the locations within the property. They are perfect for your ceremony, drinks , reception or for taking photos that capture your perfect day*





From the grounds of the Homestead, it is a lovely walk over the gorgeous old foot bridge to your Marquee or up to the Shearing Shed for your reception.





# THE SHEARING SHED

*The Shearing is a large blank canvas.  
Its the perfect spot to hold a reception and is  
included in the venue hire fee.*





The Shearers quarters at Barunah Plains are the ideal spot for guests to stay. Sleeping 41 people in 15 rooms. Large living, dining spaces and a full kitchen make it a perfect spot for your recovery.

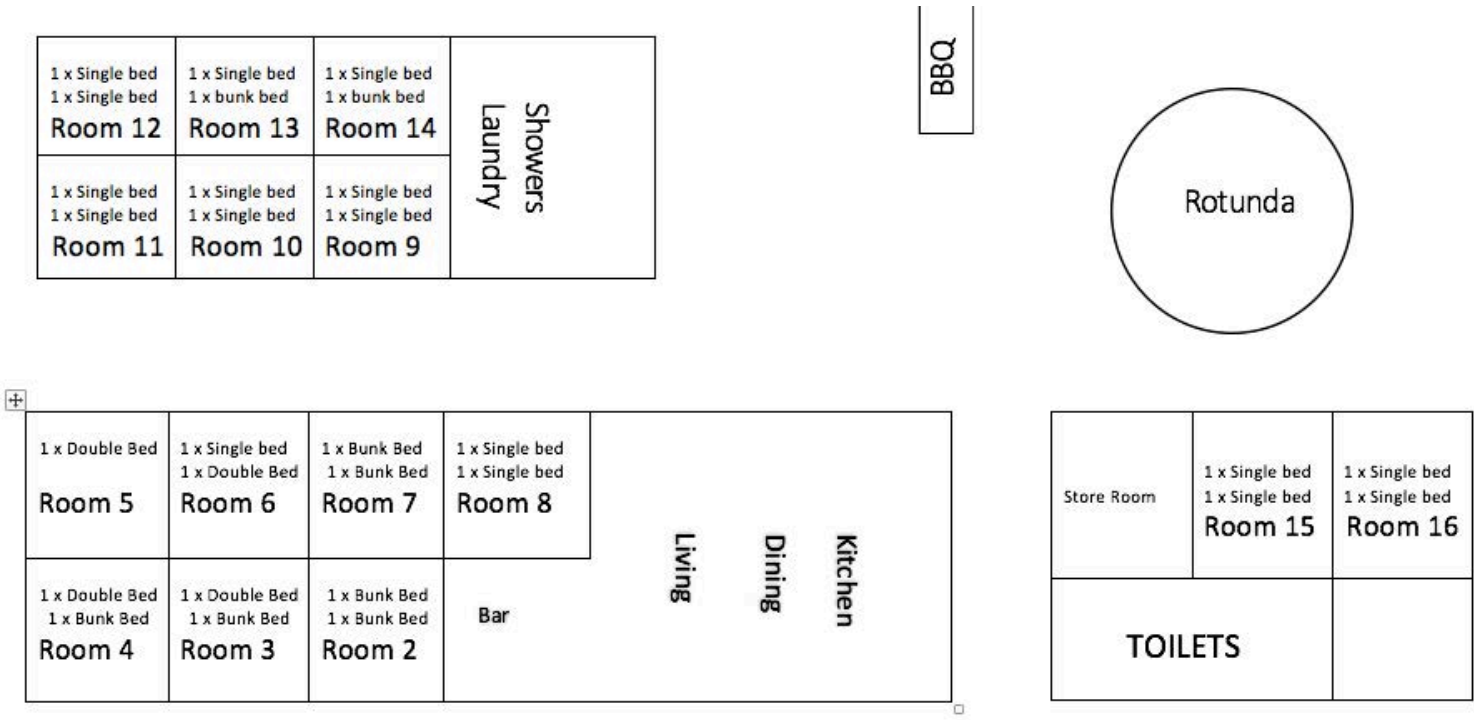



# T he homestead

Sleeping up to 22 people the homestead at Barunah Plains is the perfect spot to stay. With 10 bedrooms homestead has been restored and has all the added conveniences for todays living. A large cooks Kitchen with aga oven, 4 bathrooms, billiards room, drawing Room, 2 TV rooms, Dining room, Ball room divided in to another living space and dining room, swimming pool with pool house, tennis court, cricket net, 4 acres of manicured garden and 840 acres to explore.











The Cottage at Barunah Plains is two bedrooms and has recently been done up and is the perfect spot to get ready or relax before or after your wedding. It has one king room & one queen room.







# BARUNAH PLAINS

## COSTINGS

<b>Venue Hire</b>	\$12,000	Venue hire inc Shearing shed. Please note if you are booking the venue only the fee is \$15,000
<b>Homestead</b>	\$6900	for two nights . Any additional nights \$3000 p/n
<b>Shearers Quarters</b>	\$4000	for two nights (minimum two night booking) <b>Linen Shearers Quarters</b> if requested \$30 per bed
<b>Cottage</b>	\$500	for two nights*
<b>Security Deposit</b>	\$2000	retuned to you after your event..
<b>Security</b>	\$600	(Security on site for the duration of your event to protect our property)
<b>Rubbish Removal -</b>	\$750	You are required to remove all rubbish from your event. We can do this for you for an extra cost.

\*Please note if the Homestead is booked The Cottage will not be available for hire.





## BARUNAH PLAINS

PASTORAL COMPANY

4484 Hamilton Highway, Hesse 3321

0409 158 706

[accommodation@barunahplains.com.au](mailto:accommodation@barunahplains.com.au)

[www.barunahplains.com.au](http://www.barunahplains.com.au)